

# ALUMINIUM COMPOSITE CLADDING SYSTEM

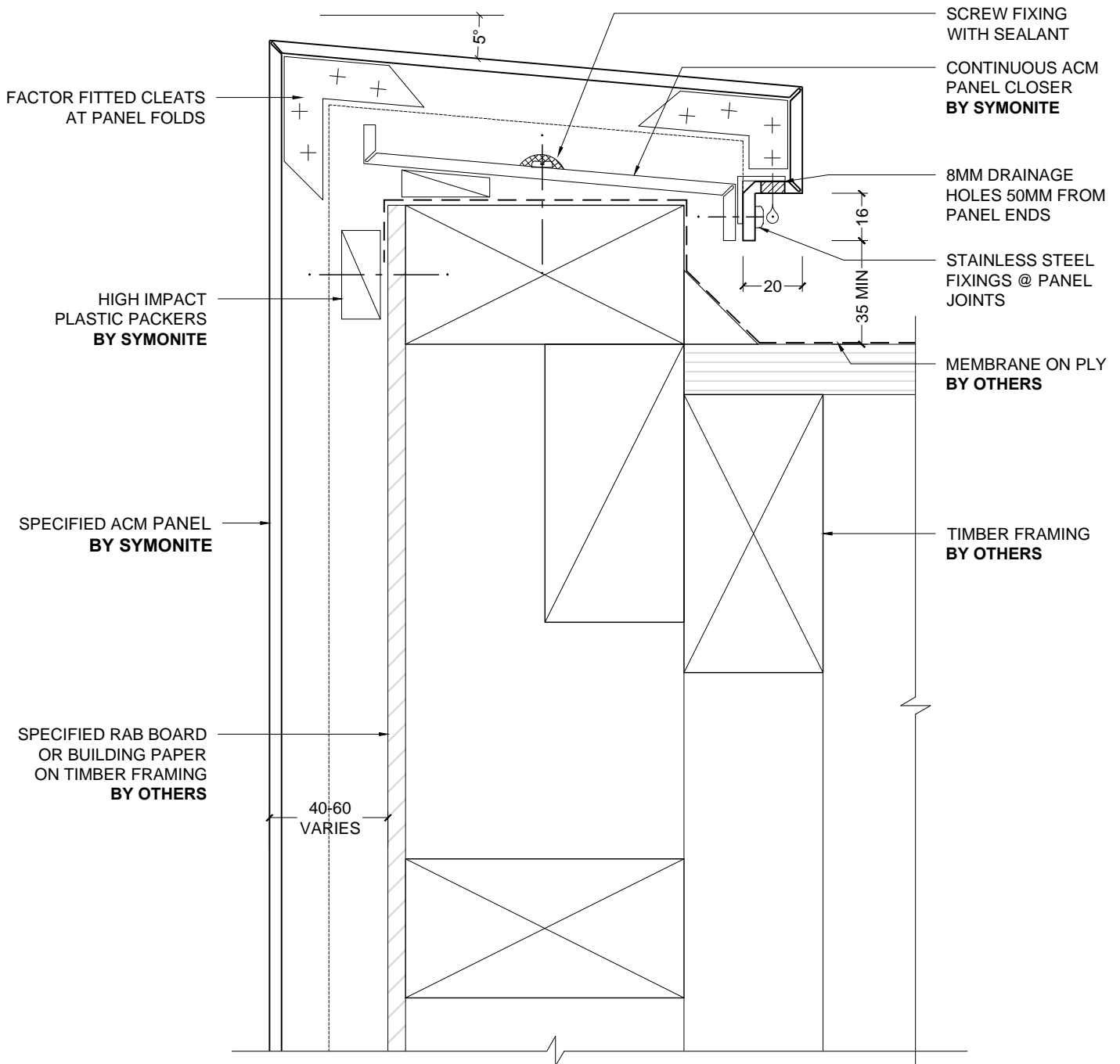

**NOTE:**

- 1) FOR USE WITH LOW ROOF UPSTAND LAP ONLY
- 2) THIS DETAIL DOES NOT MEET BUILDING CODE REQUIREMENTS BUT MAY BE OFFERED AS AN ACCEPTABLE SOLUTION
- 3) IT IS THE BUILDER / ARCHITECTS RESPONSIBILITY TO ENSURE THAT THIS DETAIL IS SATISFACTORY AND SPECIFIC INSTRUCTION IS REQUIRED FOR THIS DETAIL TO BE EMPLOYED



**1 PARAPET WITH MINIMAL UPSTAND**

1:2 @ A4