

# ALICLAD

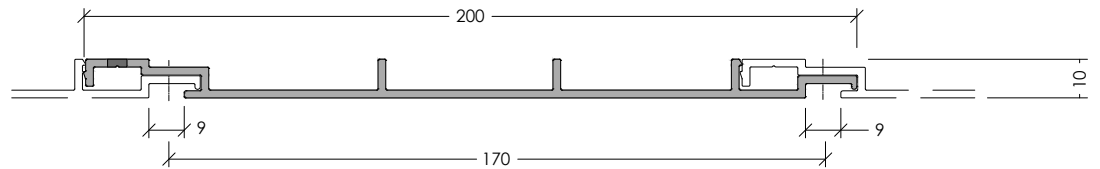



## S170

Square Groove Wall & Soffit Lining -

- 170mm Coverage
- 7.8kg/m<sup>2</sup>

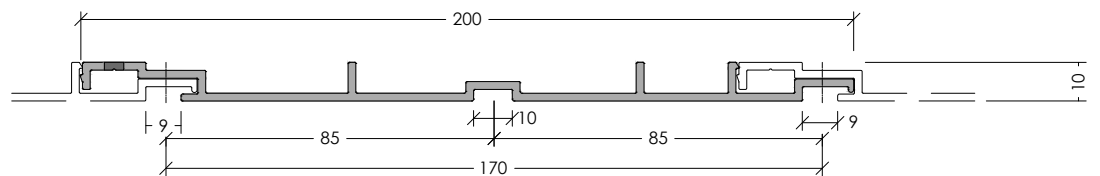

## S085

Square Groove Wall & Soffit Lining -

- 170mm Coverage
- 8kg/m<sup>2</sup>

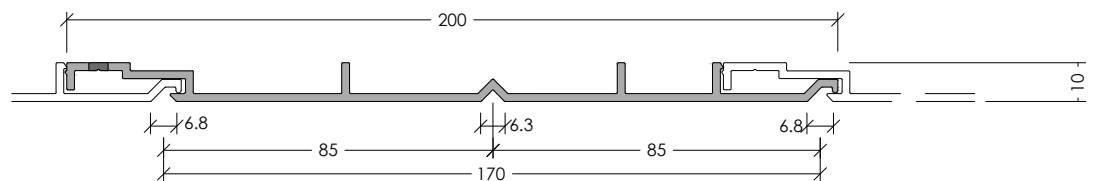

## V085

Vee Groove Wall & Soffit Lining -

- 170mm Effective Coverage
- 7.8kg/m<sup>2</sup>

# ALICLAD

JMDB

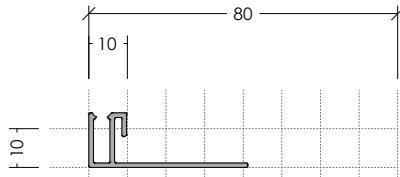

Trim Base, 3.6m, Selected Finish.

HMDB

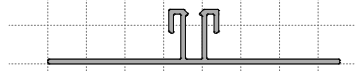

Jointer Base, 3.6m.

SJMDB

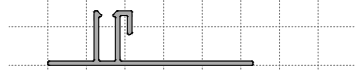

Shadow Base, 3.6m, Selected Finish.

HMDF

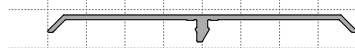

80mm Jointer Face - 10mm, 3.6m, Selected Finish.

JMDF

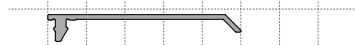

50mm Trim Face - 10mm, 3.6m, Selected Finish.

ORDER SHEET:	_____
CUSTOMER NAME:	_____
PO#:	_____
COLOUR:	_____

## ACCESORIES

Detail Number \_\_\_\_\_

ACC-01

Scale \_\_\_\_\_ Version \_\_\_\_\_

A4 1:2 [2.0] - Aug 2024



**MATERIALS • SYSTEMS • SOLUTIONS**

**JMB**

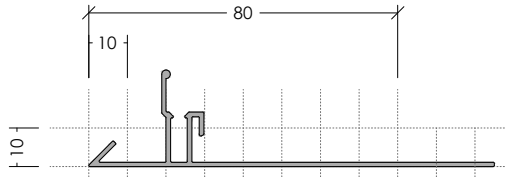

Jamb Base, 3.6m,  
Selected Finish.

**BOC**



Bottom of Cladding Base, 3.6m,  
Punched, Selected Finish.

**INTB**

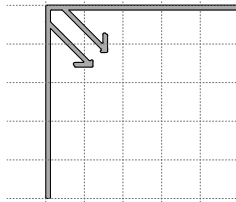

Internal Corner Base, 3.6m,  
Selected Finish.

**INTF**

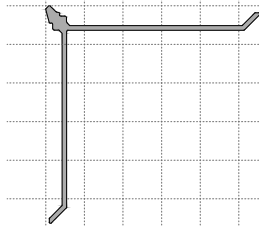

Internal Corner Face, 3.6m,  
Selected Finish.

**EXTB**

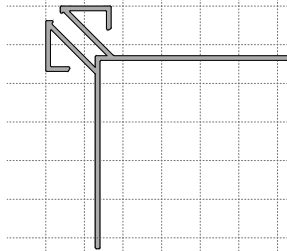

External Corner Base, 3.6m,  
Selected Finish.

**EXTF**

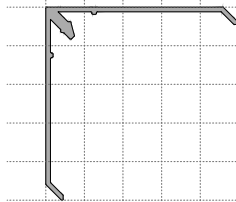

External Corner Face, 3.6m,  
Selected Finish.

## ACCESORIES

Detail Number \_\_\_\_\_

ACC-02

Scale \_\_\_\_\_ Version \_\_\_\_\_

A4 1:2 [1.0] - May 2024



**MATERIALS • SYSTEMS • SOLUTIONS**

# ALICLAD



Trim Base



50 mm Trim Face - 10mm

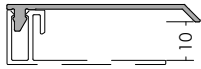

Jointer Base



80mm Jointer Face - 10mm

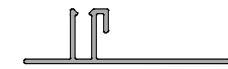
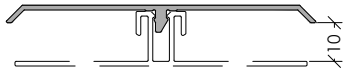

Shadow Base



50 mm Trim Face - 10mm

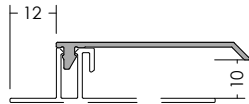

Jamb Base



50 mm Trim Face - 10mm



## COMMON CLADDING ACCESSORY PAIRINGS

Detail Number \_\_\_\_\_  
ACC-03  
Scale \_\_\_\_\_ Version \_\_\_\_\_  
A4 1:2 [2.0] - Aug 2024



MATERIALS • SYSTEMS • SOLUTIONS

# ALICLAD



Bottom of Cladding Base

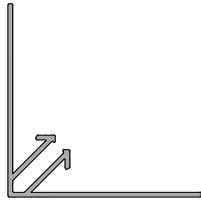
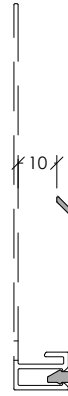

Internal Corner Base

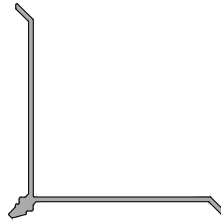

Internal Corner Face

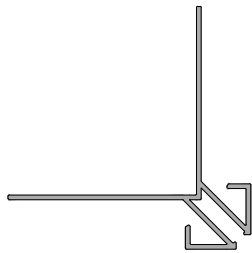
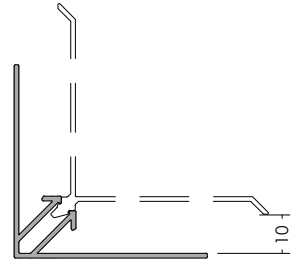

External Corner Base

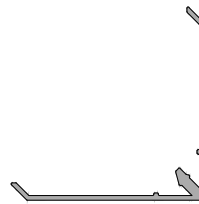

External Corner Face

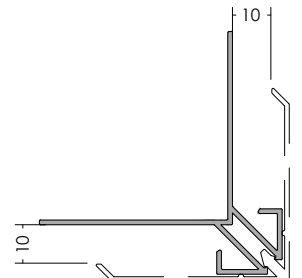

## COMMON CLADDING ACCESSORY PAIRINGS

Detail Number  
\_\_\_\_\_ ACC-04  
Scale \_\_\_\_\_ Version \_\_\_\_\_  
A4 1:2 [1.0] - May 2024



MATERIALS • SYSTEMS • SOLUTIONS

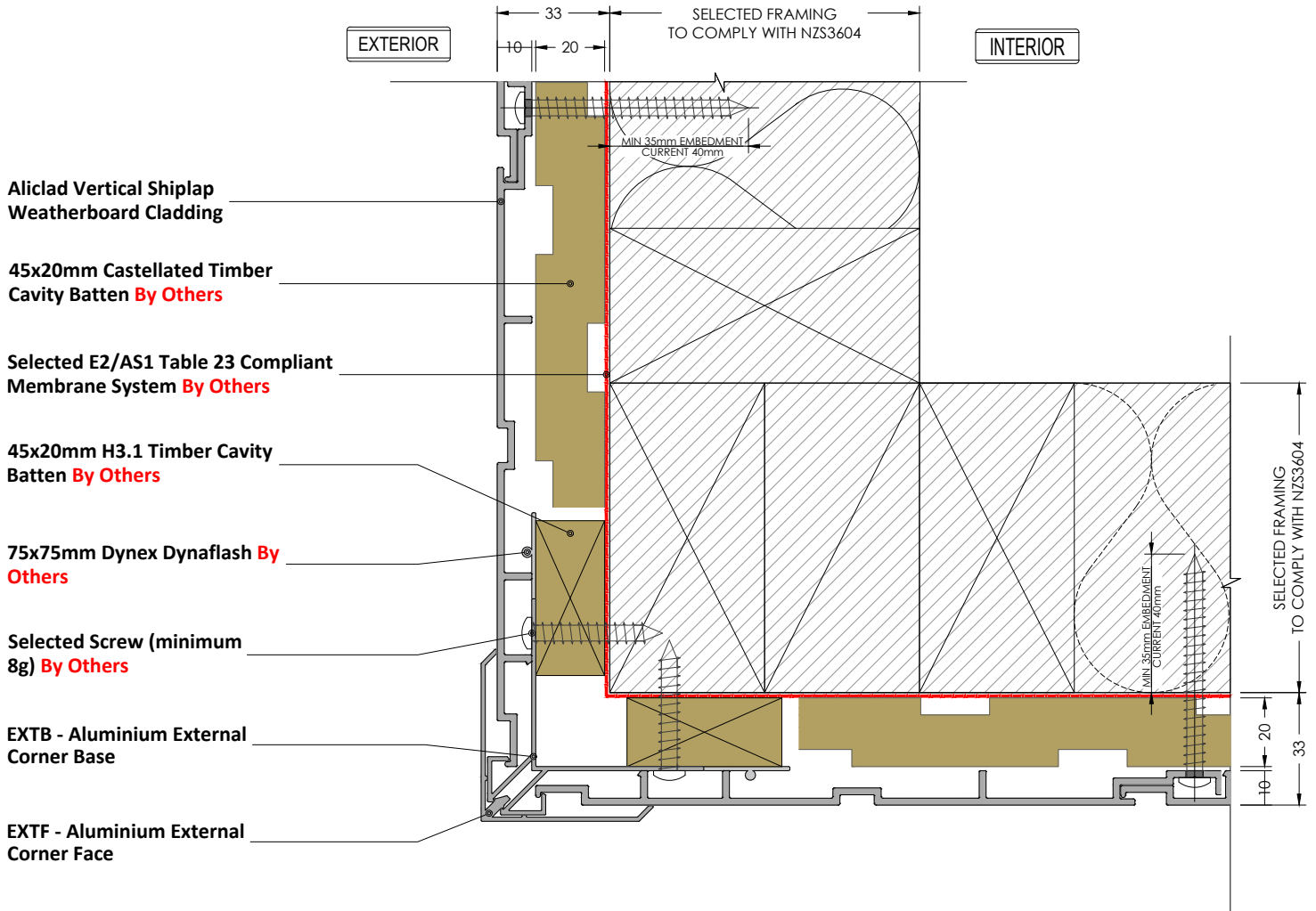

Alternative When Board is Cut

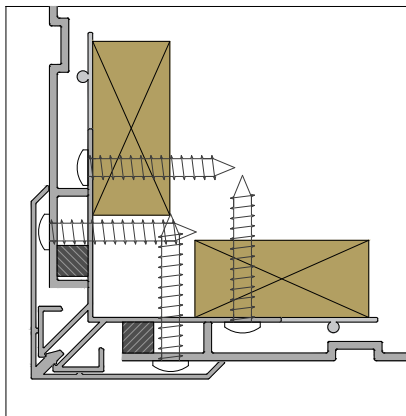

Refer to Test Report  
SWTL R0067



## EXTERNAL CORNER

Detail Number	
Scale	Version
A4 1:2	[2.0] - Aug 2024

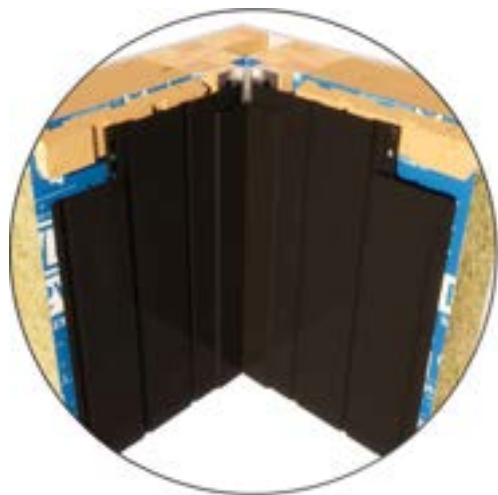
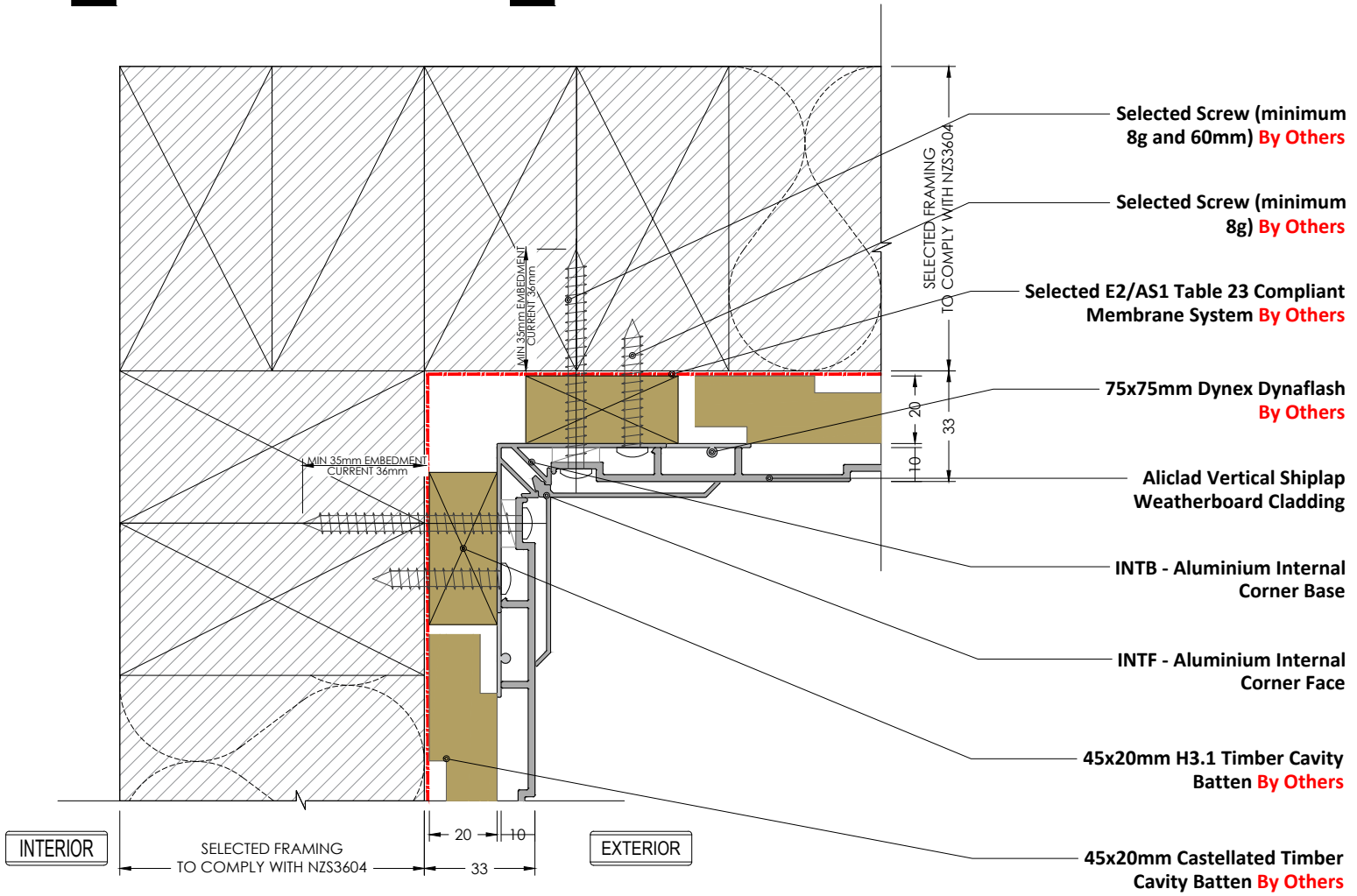

Alternative When Board is Cut

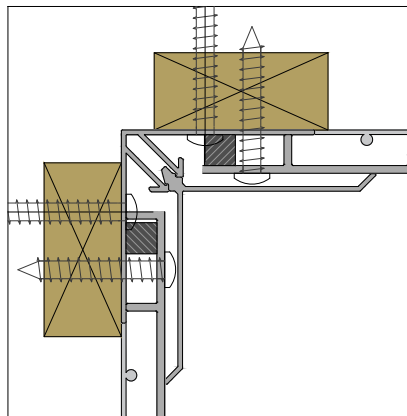

Refer to Test Report  
SWTL R0067



## INTERNAL CORNER

Detail Number \_\_\_\_\_  
Scale \_\_\_\_\_ Version 2.0  
A4 1:2 [2.0] - Aug 2024



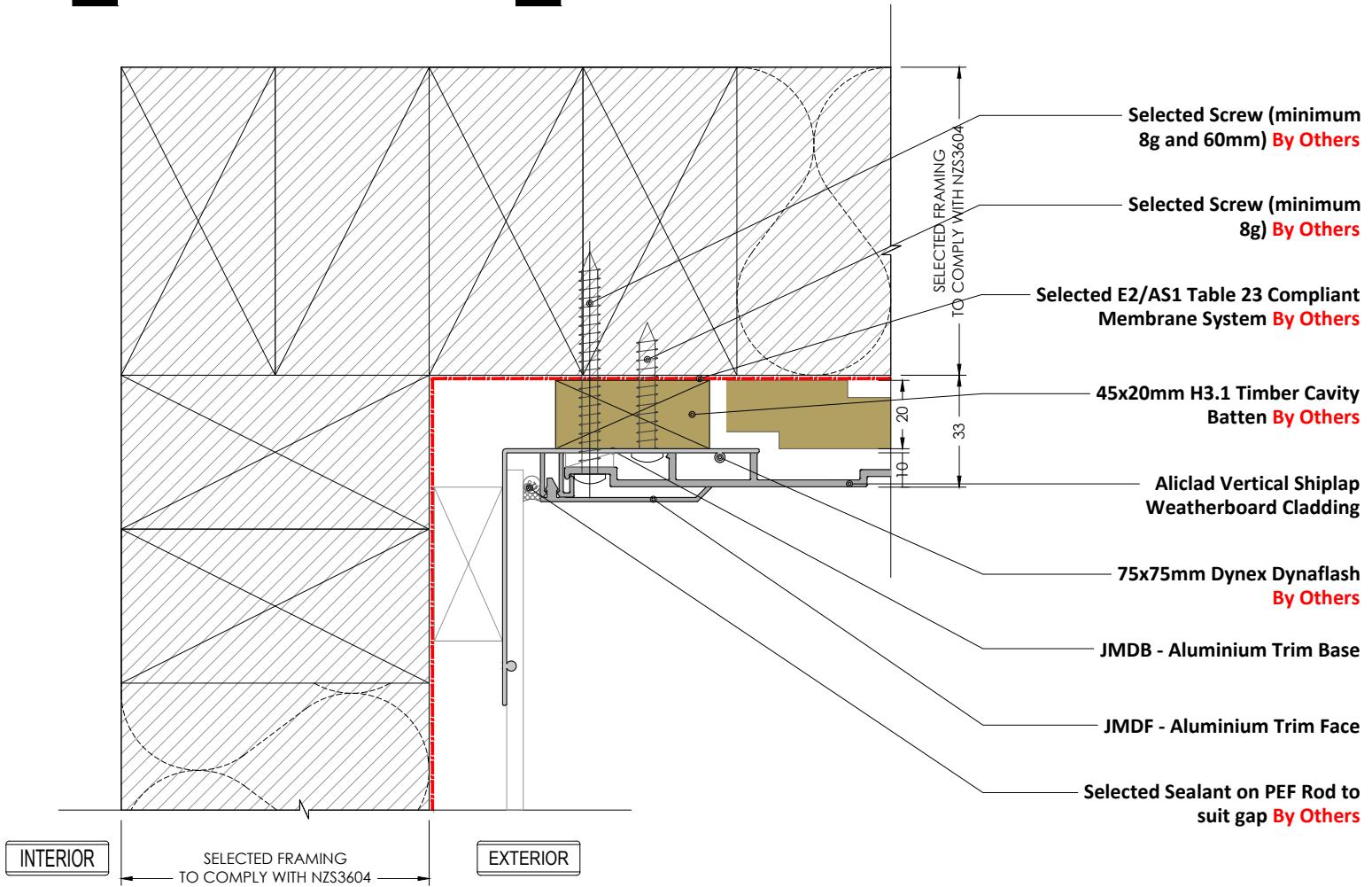

Alternative When Board is Cut

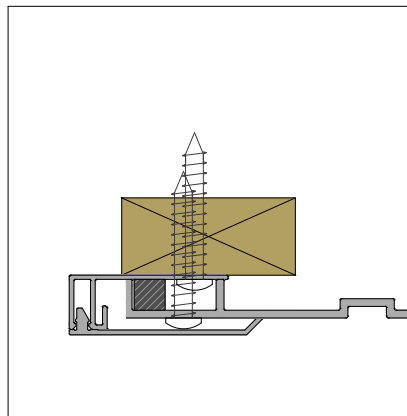

## INTERNAL CORNER AT ALTERNATE CLADDING

Detail Number	
Scale	Version
A4 1:2	[2.0] - Aug 2024

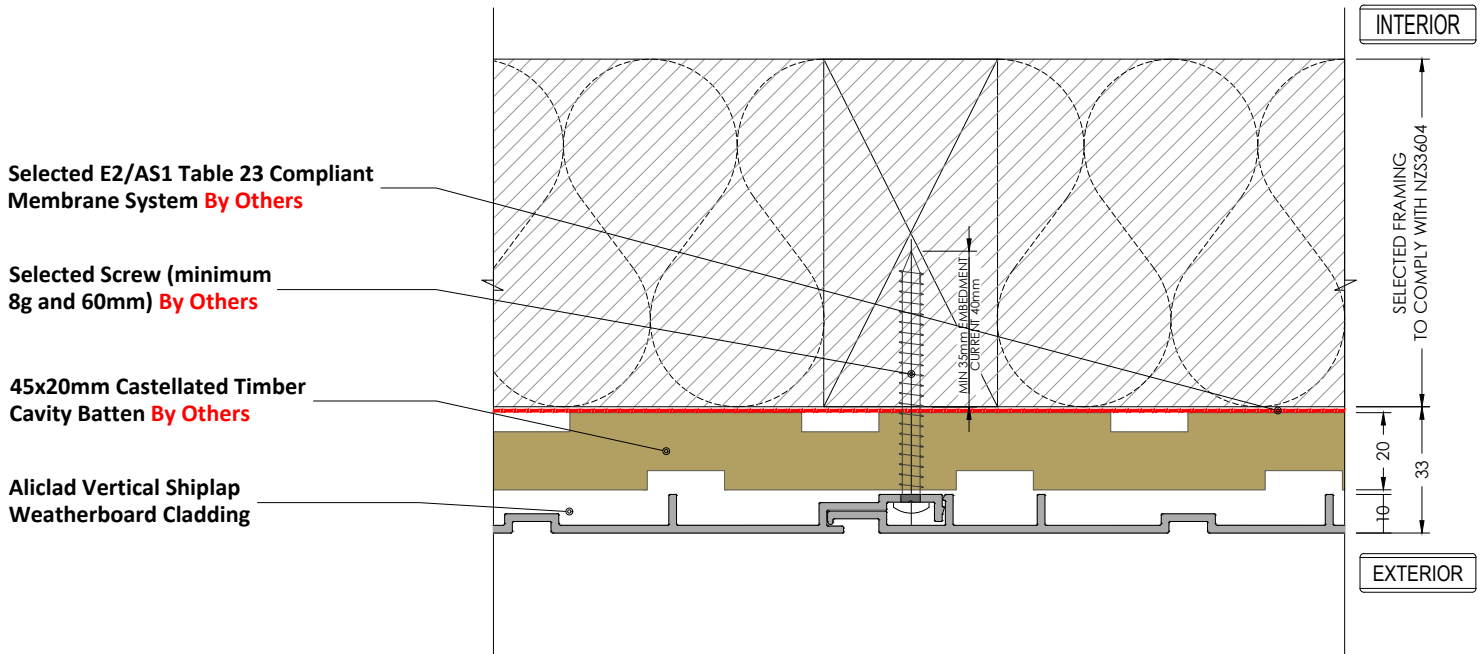

Refer to Test Report  
SWTL R0067



## TYPICAL VERTICAL JOINT

Detail Number \_\_\_\_\_ 3.0

Scale \_\_\_\_\_ Version \_\_\_\_\_

A4 1:2 [2.0] - Aug 2024



MATERIALS • SYSTEMS • SOLUTIONS

Selected E2/AS1 Table 23 Compliant  
Membrane System **By Others**

Selected Screw (minimum  
8g) **By Others**

45x20mm H3.1 Timber Cavity  
Batten **By Others**

HMDB - Aluminium Joints Base

75x75mm Dynex Dynaflash  
**By Others**

HMDF - Aluminium Joints Face

Aliclad Vertical Shiplap  
Weatherboard Cladding

Aliclad Vertical Shiplap  
Weatherboard Cladding

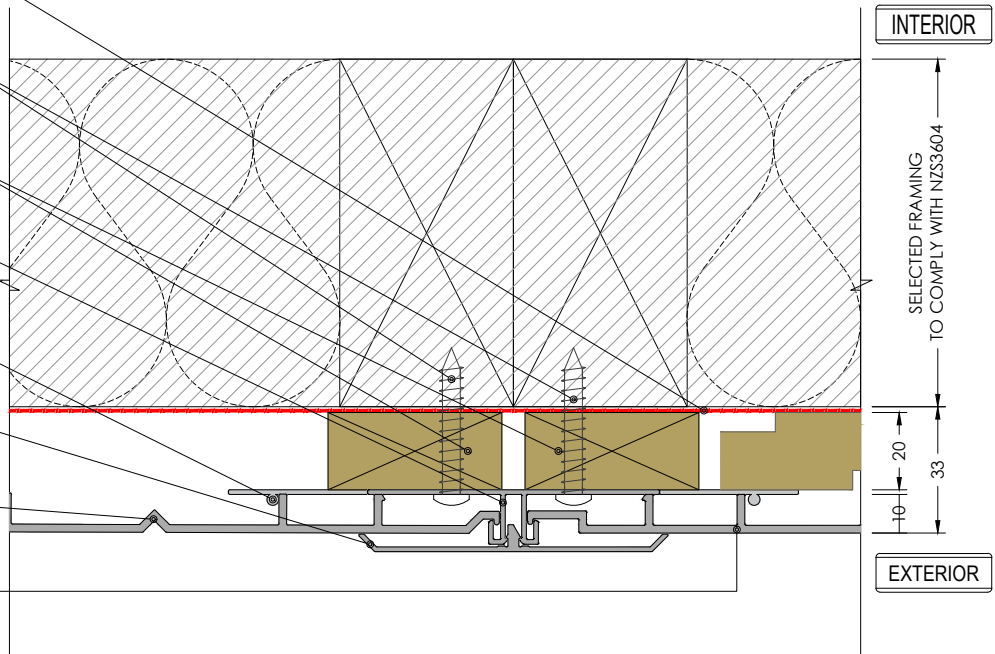

Refer to Test Report  
SWTL R0067



## VERTICAL JOINT CHANGE OF BOARD

Detail Number \_\_\_\_\_  
Scale \_\_\_\_\_ Version 3.1  
A4 1:2 [2.0] - Aug 2024



MATERIALS • SYSTEMS • SOLUTIONS

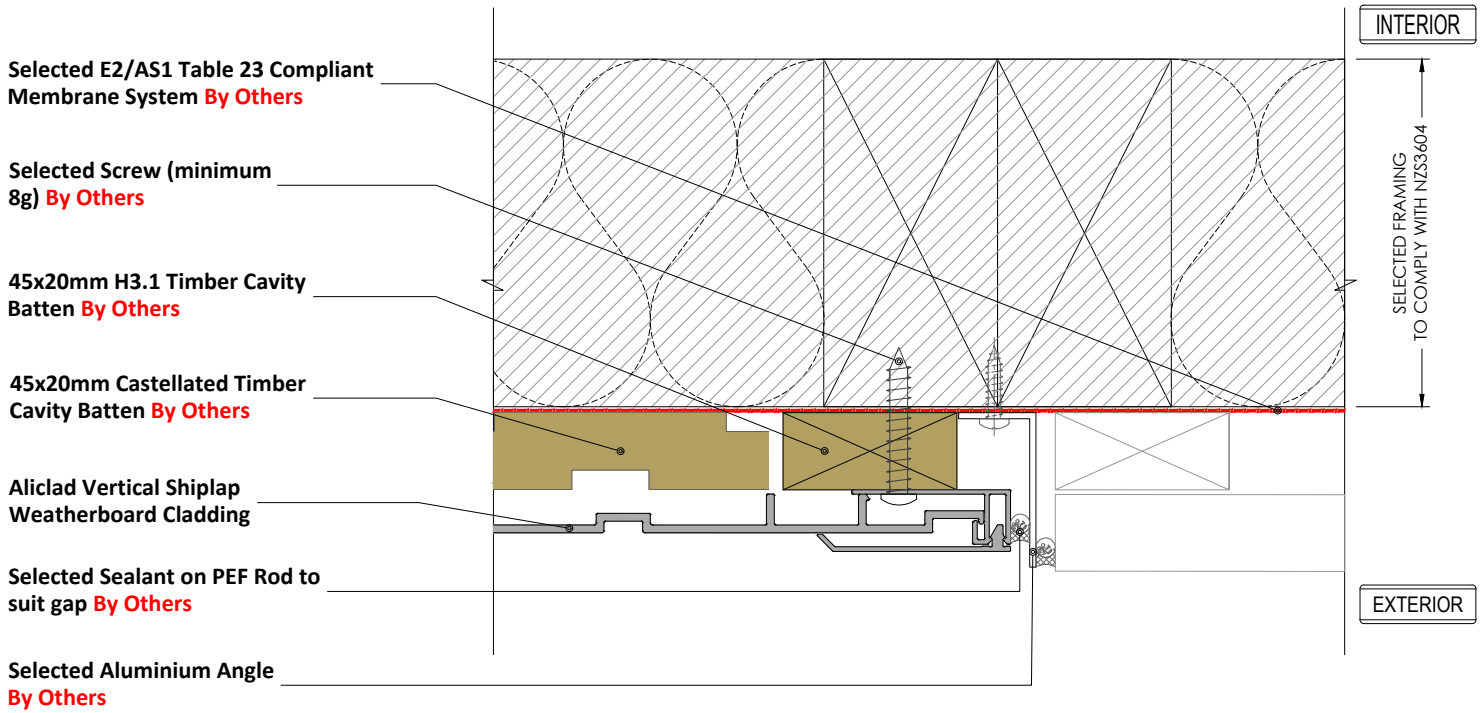

Alternative When Board is Cut

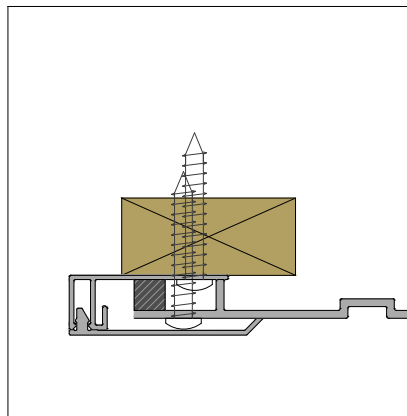

## VERTICAL JOINT AT ALTERNATE CLADDING

Detail Number \_\_\_\_\_

Scale \_\_\_\_\_ Version 3.2

A4 1:2 [2.0] - Aug 2024

Selected E2/AS1 Table 23 Compliant  
Membrane System **By Others**

Selected Flashing Tape Over Flashing  
**By Others**

45x20mm Castellated Timber  
Cavity Batten **By Others**

Selected Screw (minimum  
8g) **By Others**

JMDF - Aluminium Trim Face

Selected Cavity Closure **By Others**

BOC - Aluminium Bottom of Cladding Base

Selected Al. Custom Folded **By Others**

Aliclad Vertical Shiplap  
Weatherboard Cladding

Selected Screw (minimum  
8g and 60mm) **By Others**

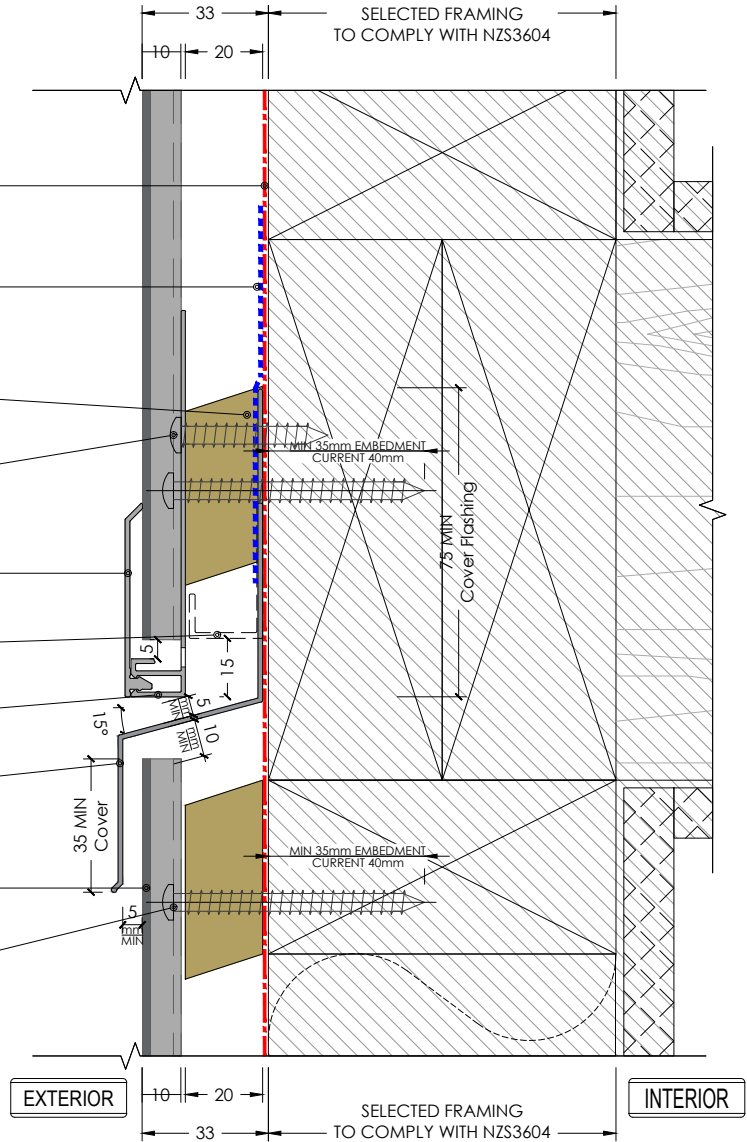

Refer to Test Report  
SWTL R0067



## HORIZONTAL JOINT INTERSTOREY JOINT

Detail Number \_\_\_\_\_  
Scale \_\_\_\_\_ Version \_\_\_\_\_  
A4 1:2 [2.0] - Aug 2024

Aliclad Vertical Shiplap  
Weatherboard Cladding

Selected E2/AS1 Table 23 Compliant  
Membrane System **By Others**

Selected Screw (minimum  
8g and 60mm) **By Others**

Selected Flashing Tape Over Flashing  
**By Others**

45x20mm Castellated Timber  
Cavity Batten **By Others**

BOC - Aluminium Bottom of Cladding Base

Selected Cavity Closure **By Others**

JMDF - Aluminium Trim Face

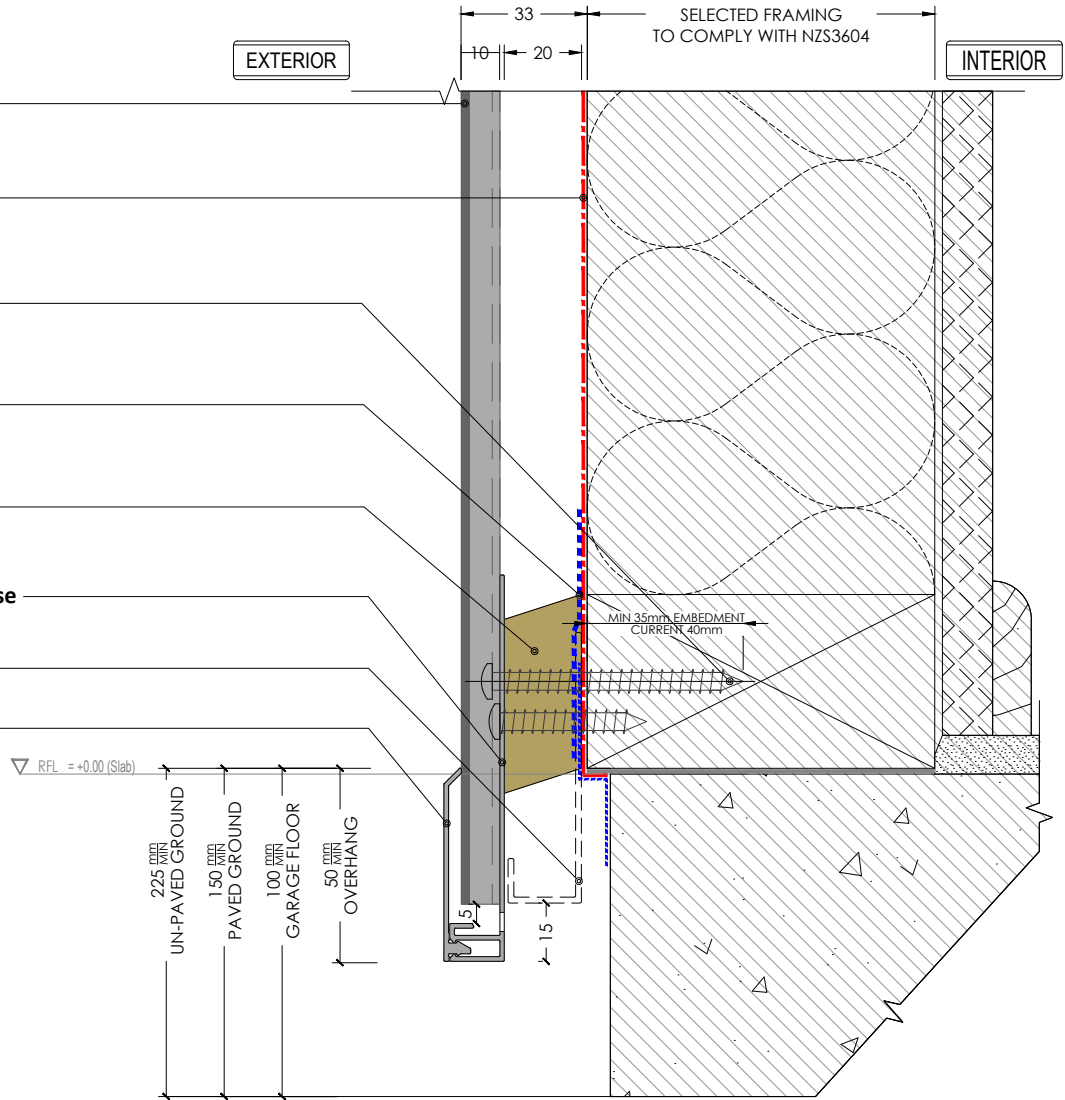

Refer to Test Report  
SWTL R0067



## TYPICAL CLADDING BASE AT FLOOR SLAB

Detail Number \_\_\_\_\_  
Scale \_\_\_\_\_ Version 5.0  
A4 1:2 [2.0] - Aug 2024

Aliclad Vertical Shiplap  
Weatherboard Cladding

Selected E2/AS1 Table 23 Compliant  
Membrane System **By Others**

45x20mm Castellated Timber  
Cavity Batten **By Others**

Selected Flashing Tape Over Flashing  
**By Others**

Selected Screw (minimum  
8g and 60mm) **By Others**

Selected Screw (minimum  
8g) **By Others**

JMDF - Aluminium Trim Face

Selected Cavity Closure **By Others**

BOC - Aluminium Bottom of Cladding Base

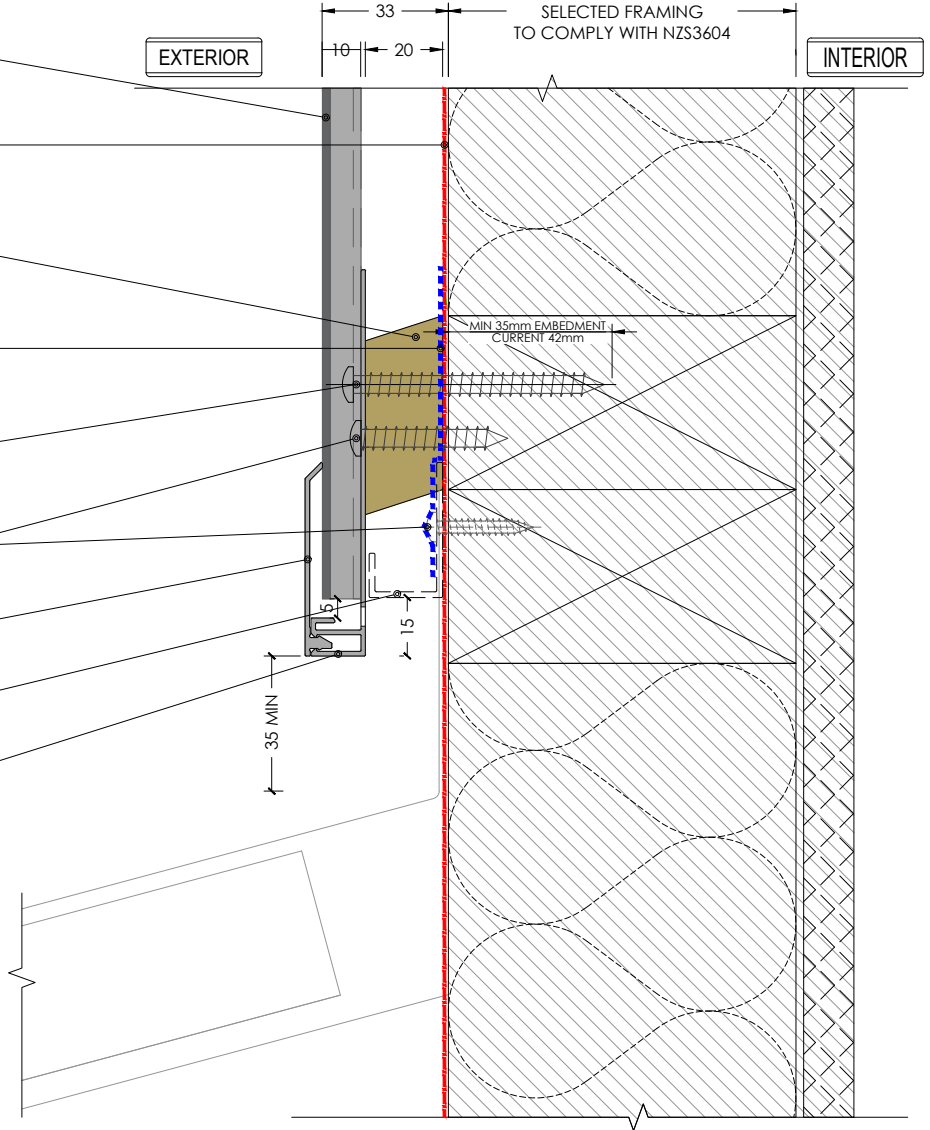

## TYPICAL CLADDING BASE AT ROOF

Detail Number

5.1

Scale Version

A4 1:2 [2.0] - Aug 2024



MATERIALS • SYSTEMS • SOLUTIONS

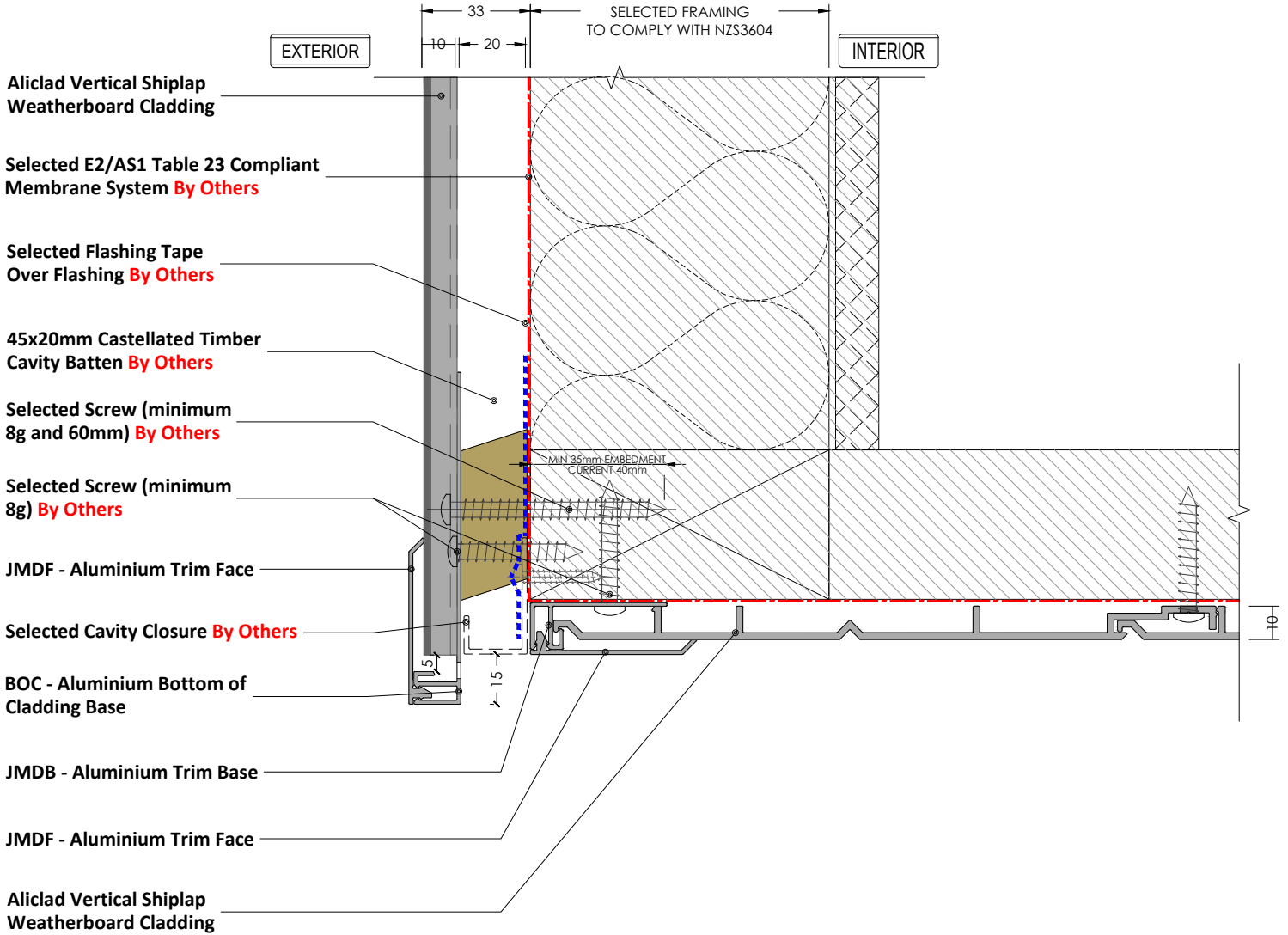

Refer to Test Report  
SWTL R0067



## TYPICAL CLADDING WALL TO SOFFIT

Detail Number \_\_\_\_\_  
Scale \_\_\_\_\_ Version 5.2  
A4 1:2 [2.0] - Aug 2024



Selected Flashing Tape AT Corner lap  
Behind Fascia **By Others**

JMDB - Aluminium Trim Base

Selected Screw (minimum  
8g) **By Others**

Selected Screw (minimum  
8g and 60mm) **By Others**

45x20mm Castellated Timber  
Cavity Batten **By Others**

JMDF - Aluminium Trim Face

Selected E2/AS1 Table 23 Compliant  
Membrane System **By Others**

Aliclad Vertical Shiplap  
Weatherboard Cladding

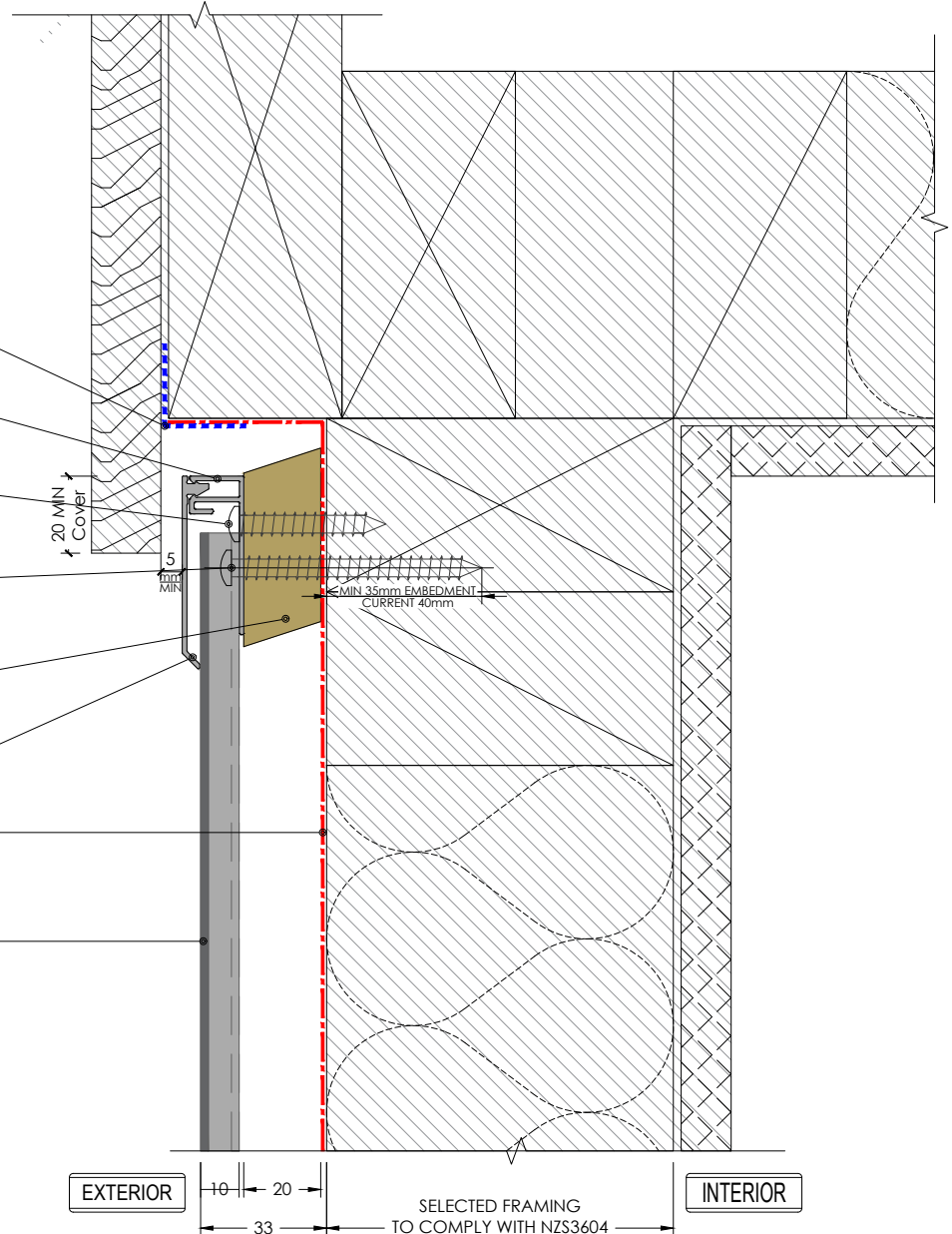

## TYPICAL CLADDING TOP AT FASCIA

Detail Number

6.0

Scale Version

A4 1:2 [2.0] - Aug 2024

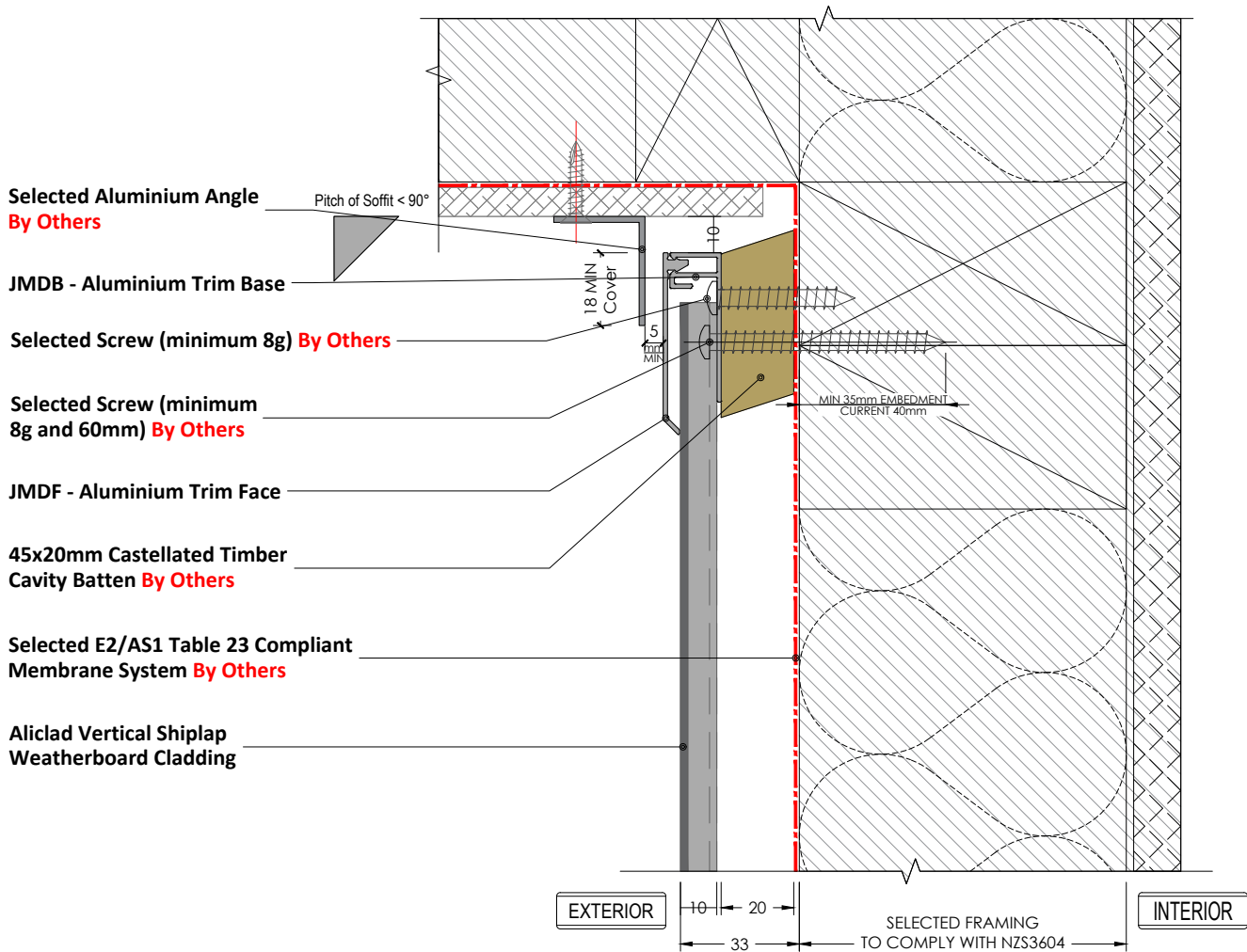

## SOFFIT / EAVE TO WALL

Detail Number  
 \_\_\_\_\_ 6.1  
 Scale          Version  
 \_\_\_\_\_  
 A4 1:2          [2.0] - Aug 2024



**MATERIALS • SYSTEMS • SOLUTIONS**

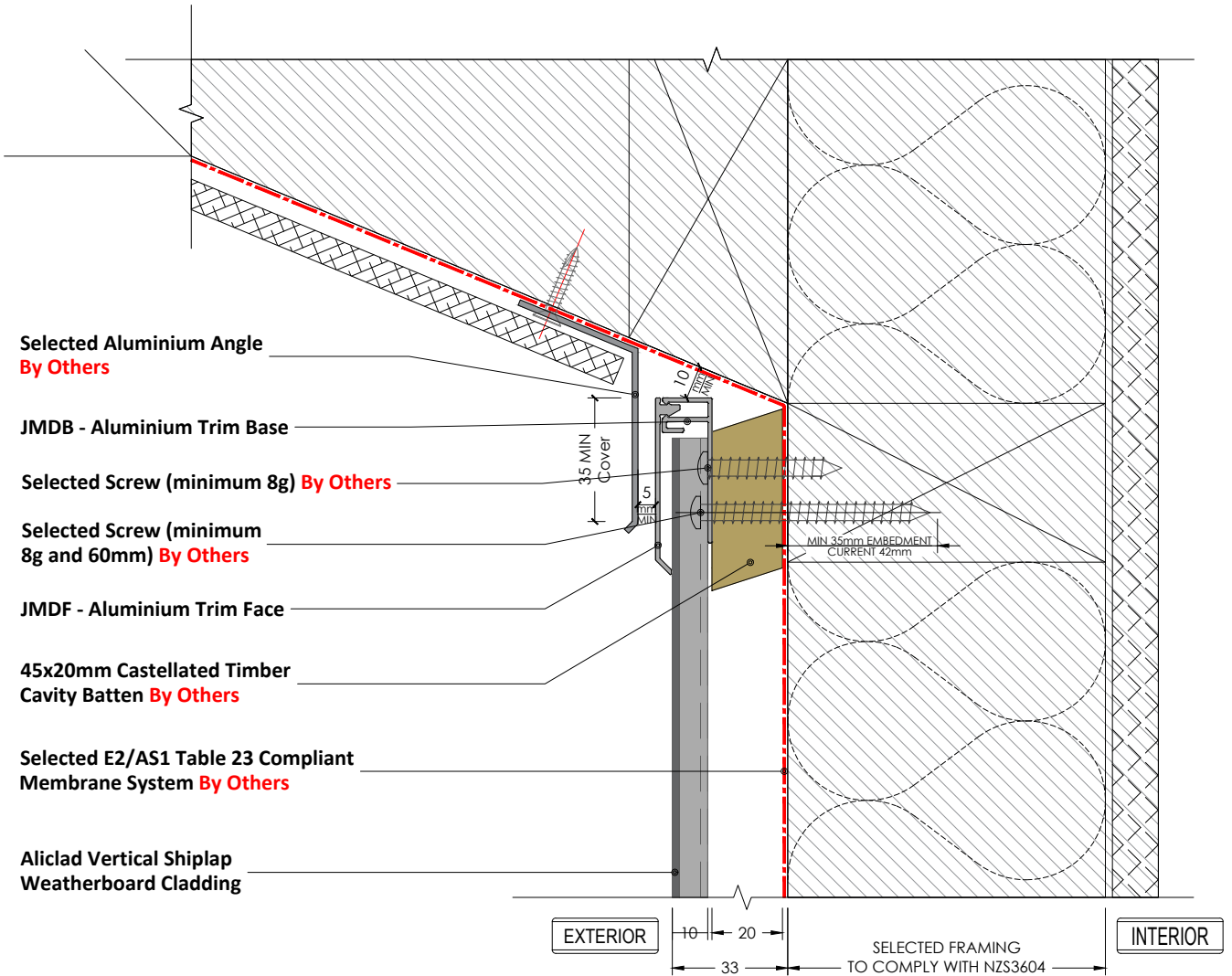

## SOFFIT / EAVE TO WALL OP.2

Detail Number \_\_\_\_\_ 6.2

Scale \_\_\_\_\_ Version \_\_\_\_\_

A4 1:2 [2.0] - Aug 2024

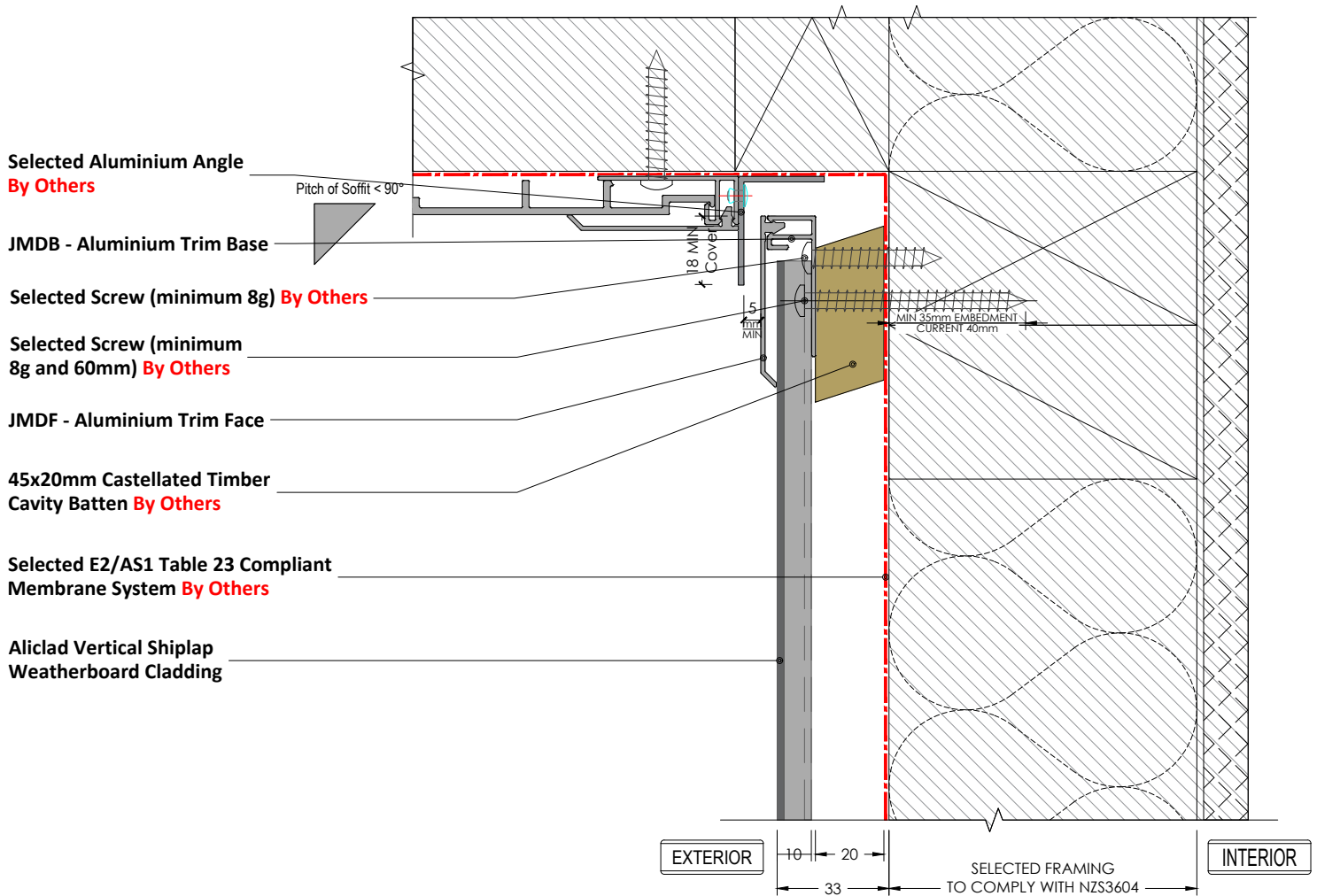

Refer to Test Report  
SWTL R0067



## SOFFIT / EAVE TO WALL OP.3

Detail Number  
6.3

Scale      Version

A4   1:2      [2.0] - Aug 2024

Selected Flashing Tape Over Building  
Wrap Jamb Return **By Others**

Selected E2/AS1 Table 23 Compliant  
Membrane System **By Others**

45x20mm H3.1 Timber Cavity  
Batten **By Others**

Selected Screw (minimum  
8g) **By Others**

45x20mm Castellated Timber  
Cavity Batten **By Others**

Danco 7412 Black EPDM Single Sided  
Foam Tape 12mmx12mm

JMDB - Aluminium Jamb Base

JMDF - Aluminium Trim Face

Aliclad Vertical Shiplap  
Weatherboard Cladding

Selected Sealant on PEF Rod to  
suit gap **By Others**

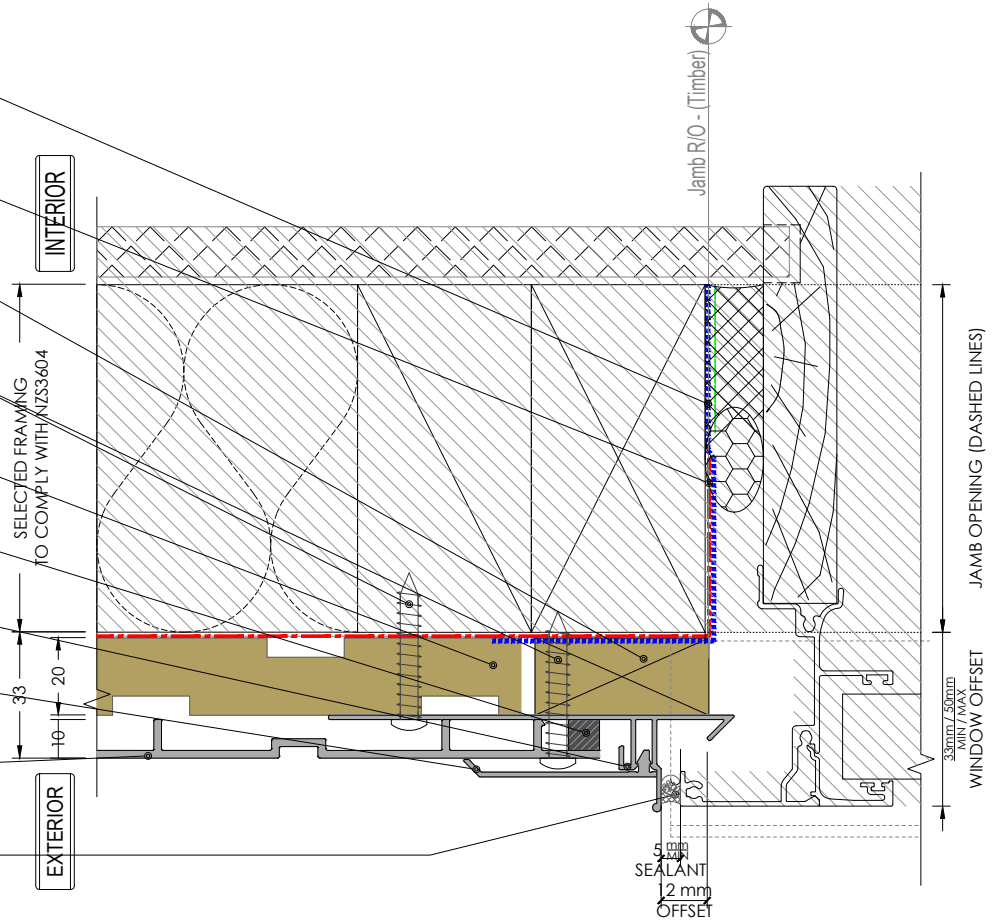

Refer to Test Report  
SWTL R0067



## TYPICAL WINDOW JAMB

Detail Number \_\_\_\_\_  
Scale \_\_\_\_\_ Version 7.0  
A4 1:2 [2.0] - Aug 2024

Aliclad Vertical Shiplap  
Weatherboard Cladding

Selected E2/AS1 Table 23 Compliant  
Membrane System **By Others**

Selected Flashing Tape Over Flashing  
**By Others**

45x20mm Castellated Timber  
Cavity Batten **By Others**

Selected Screw (minimum  
8g) **By Others**

Selected Screw (minimum  
8g and 60mm) **By Others**

JMDF - Aluminium Trim Face

Selected Cavity Closure **By Others**

BOC - Aluminium Bottom of Cladding Base

Selected Al. Head Flashing **By Others**

Selected Flashing Tape Over Building  
Wrap Jamb Return **By Others**

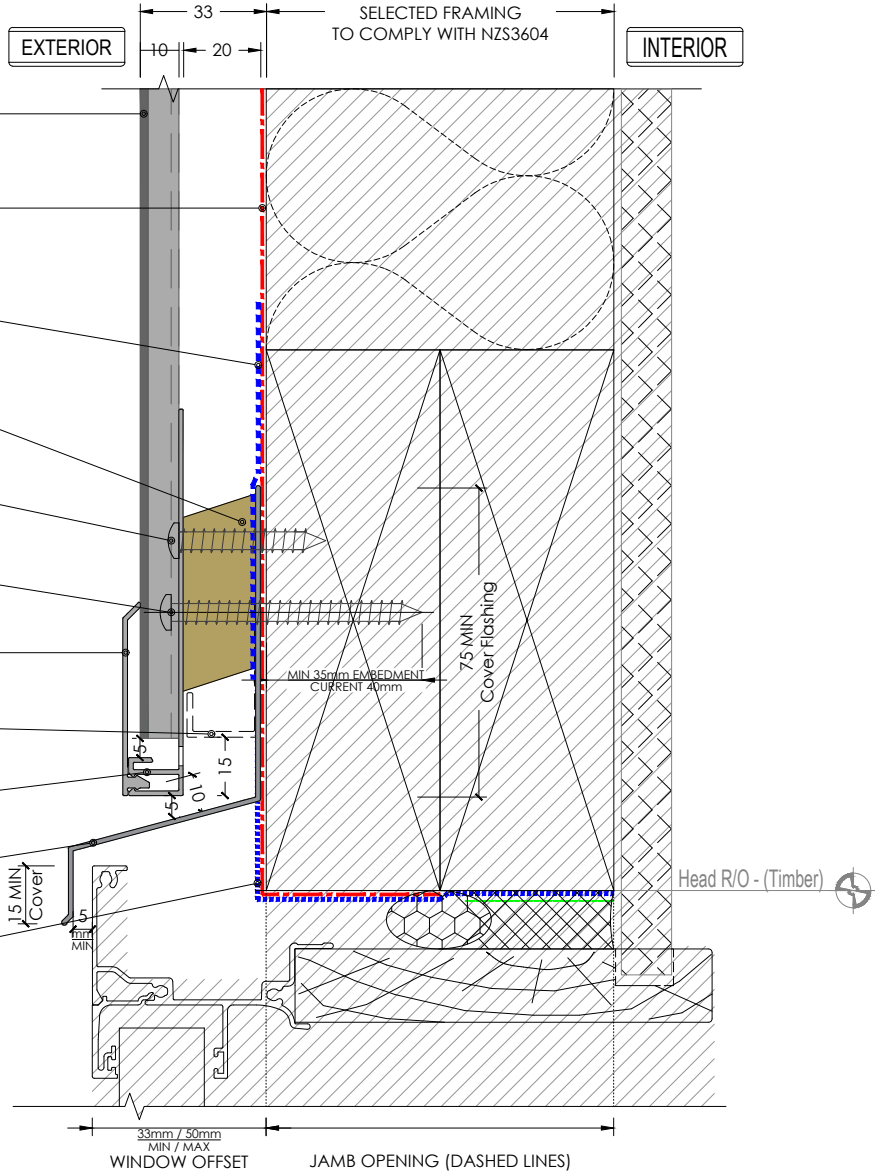

Alternative for E.H. Wind Zone

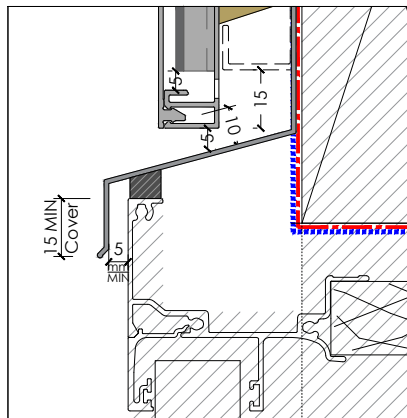

Refer to Test Report  
SWTL R0067



## TYPICAL WINDOW HEAD

Detail Number

7.1

Scale Version

A4 1:2 [2.0] - Aug 2024

**BA** THE  
BUILDING  
AGENCY

MATERIALS • SYSTEMS • SOLUTIONS

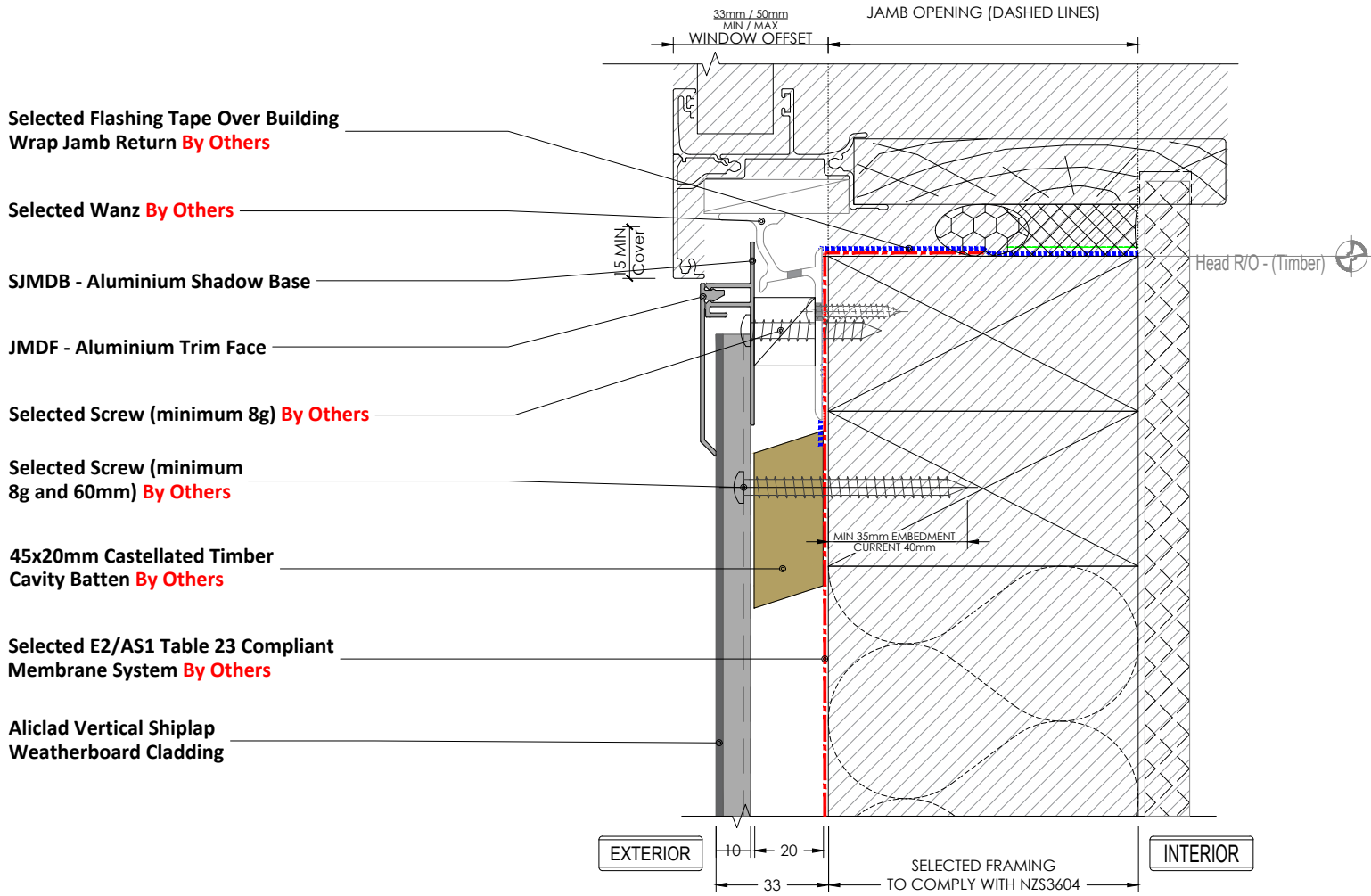

Refer to Test Report  
SWTL R0067



## TYPICAL WINDOW SILL

Detail Number \_\_\_\_\_  
7.2

Scale \_\_\_\_\_ Version \_\_\_\_\_  
A4 1:2 [2.0] - Aug 2024

Selected E2/AS1 Table 23 Compliant  
Membrane System **By Others**

Selected Aluminium Parapet  
Flashing **By Others**

Selected Screw (minimum 8g) **By Others**

Selected Packer to Suit Fix Point **By Others**

Selected Screw (minimum  
8g and 60mm) **By Others**

45x20mm Castellated Timber  
Cavity Batten **By Others**

Selected E2/AS1 Table 23 Compliant  
Membrane System **By Others**

Aliclad Vertical Shiplap  
Weatherboard Cladding

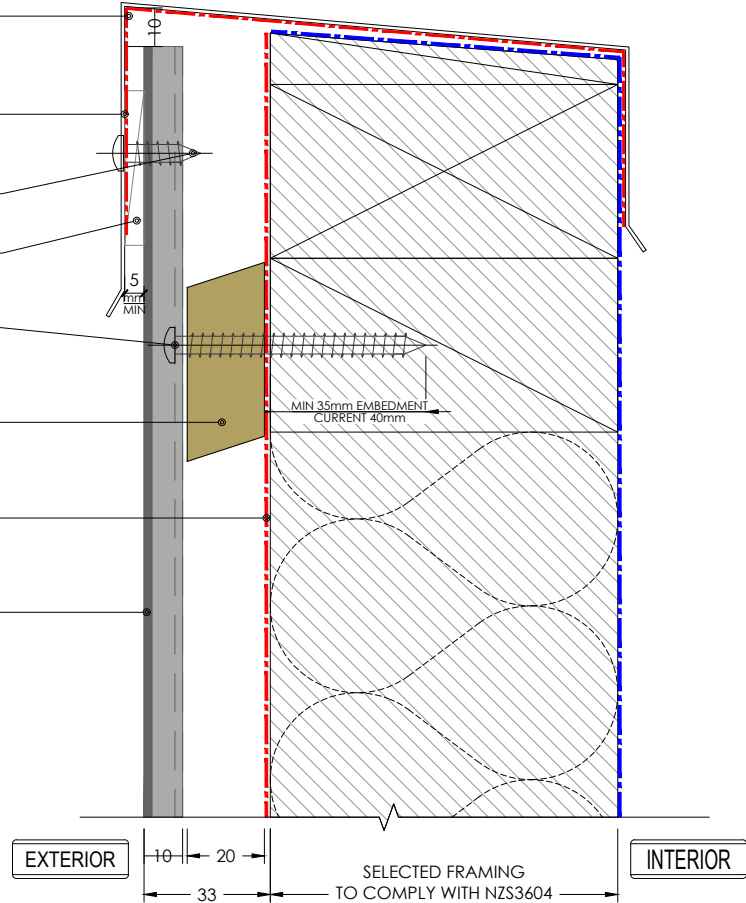

Refer to Test Report  
SWTL R0067



## TYPICAL PARAPET CAPPING

Detail Number  
\_\_\_\_\_ 8.0

Scale \_\_\_\_\_ Version \_\_\_\_\_

A4 1:2 [1.0] - Aug 2024



**MATERIALS • SYSTEMS • SOLUTIONS**



Selected E2/AS1 Table 23 Compliant  
Membrane System **By Others**

Selected Aluminium flashing  
**By Others**

Selected Screw (minimum 8g) **By Others**

Selected Packer to Suit Fix Point **By Others**

Selected Screw (minimum  
8g and 60mm) **By Others**

45x20mm Castellated Timber  
Cavity Batten **By Others**

Selected E2/AS1 Table 23 Compliant  
Membrane System **By Others**

Aliclad Vertical Shiplap  
Weatherboard Cladding

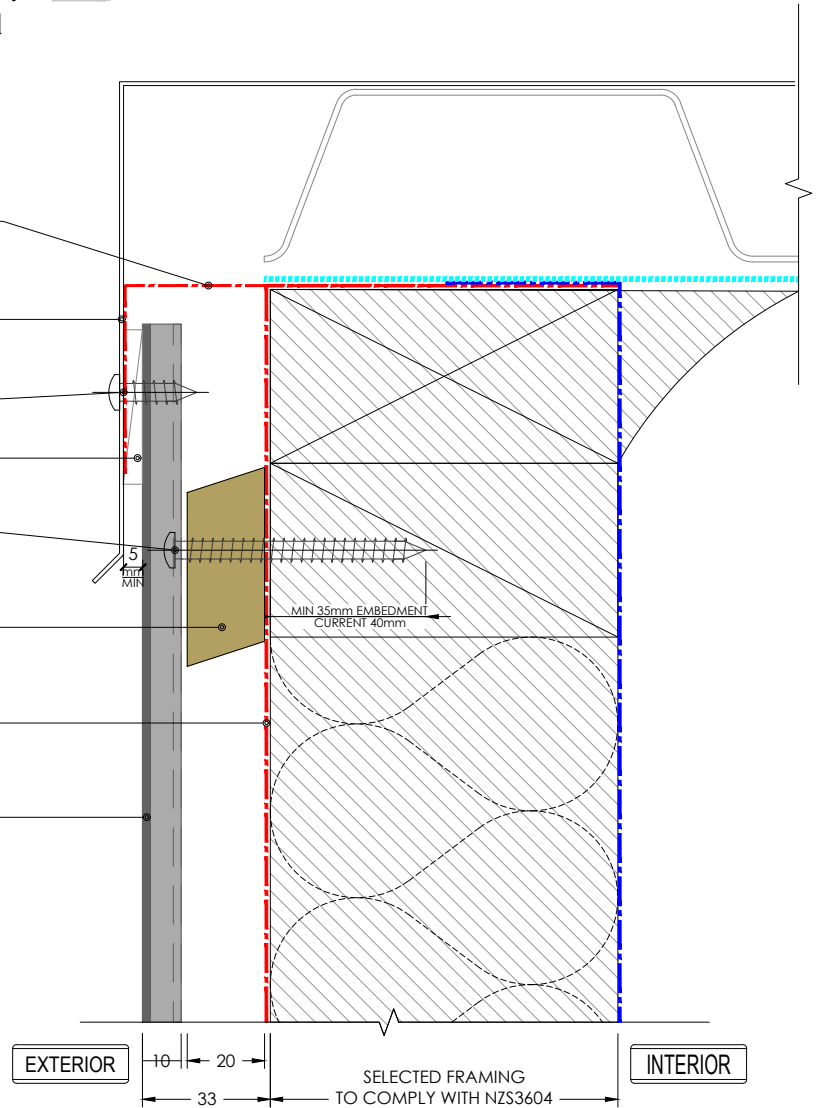

## TYPICAL TOP OF CLADDING

Detail Number

8.1

Scale

Version

A4 1:2

[1.0] - Aug 2024

Aliclad Vertical Shiplap  
Weatherboard Cladding

Selected Screw (minimum  
8g and 60mm) **By Others**

45x20mm Castillated Timber  
Cavity Batten **By Others**

Selected Cover Flange  
over Pipe **By Others**

Selected Pipe **By Others**

Selected Sealant to suit  
gap **By Others**

Selected Trade Seal  
**By Others**

Selected Sealant to suit  
gap **By Others**

Selected E2/AS1 Table 23 Compliant  
Membrane System **By Others**

Aliclad Vertical Shiplap  
Weatherboard Cladding

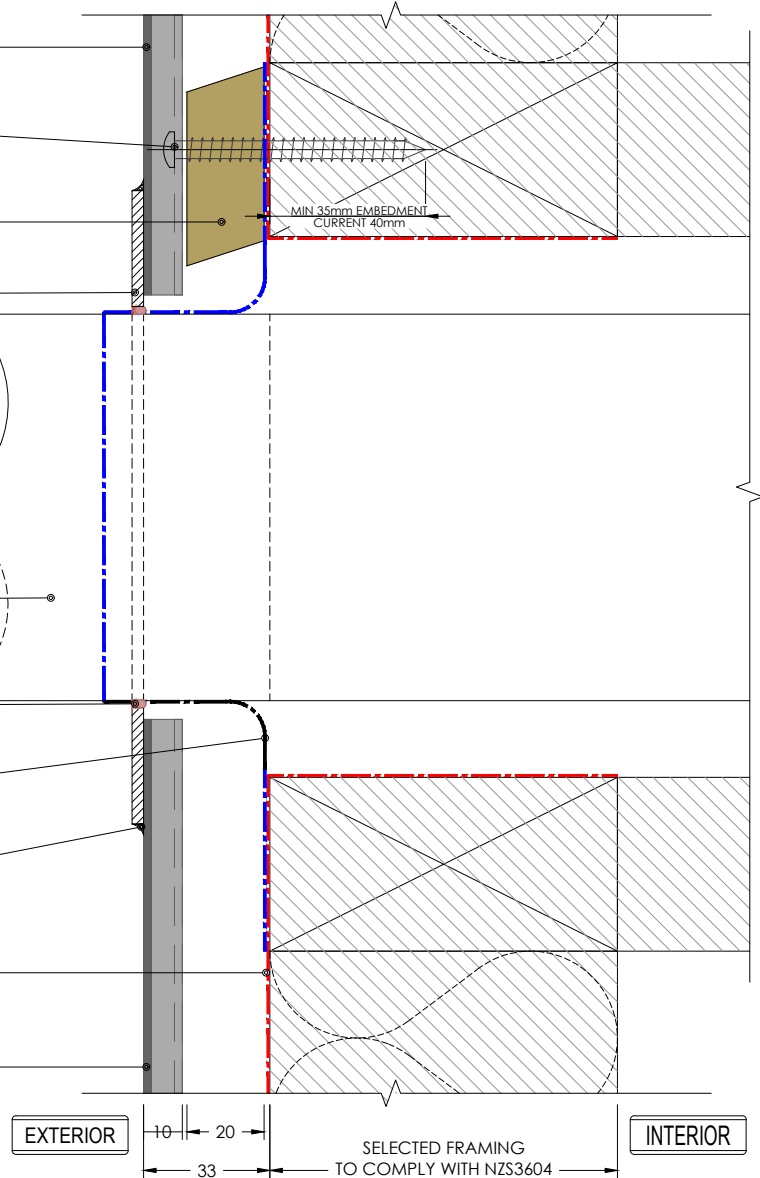

Refer to Test Report  
SWTL R0067



## TYPICAL PIPE PENETRATION

Detail Number  
\_\_\_\_\_  
9.0

Scale      Version  
\_\_\_\_\_  
A4 1:2      [1.0] - Aug 2024

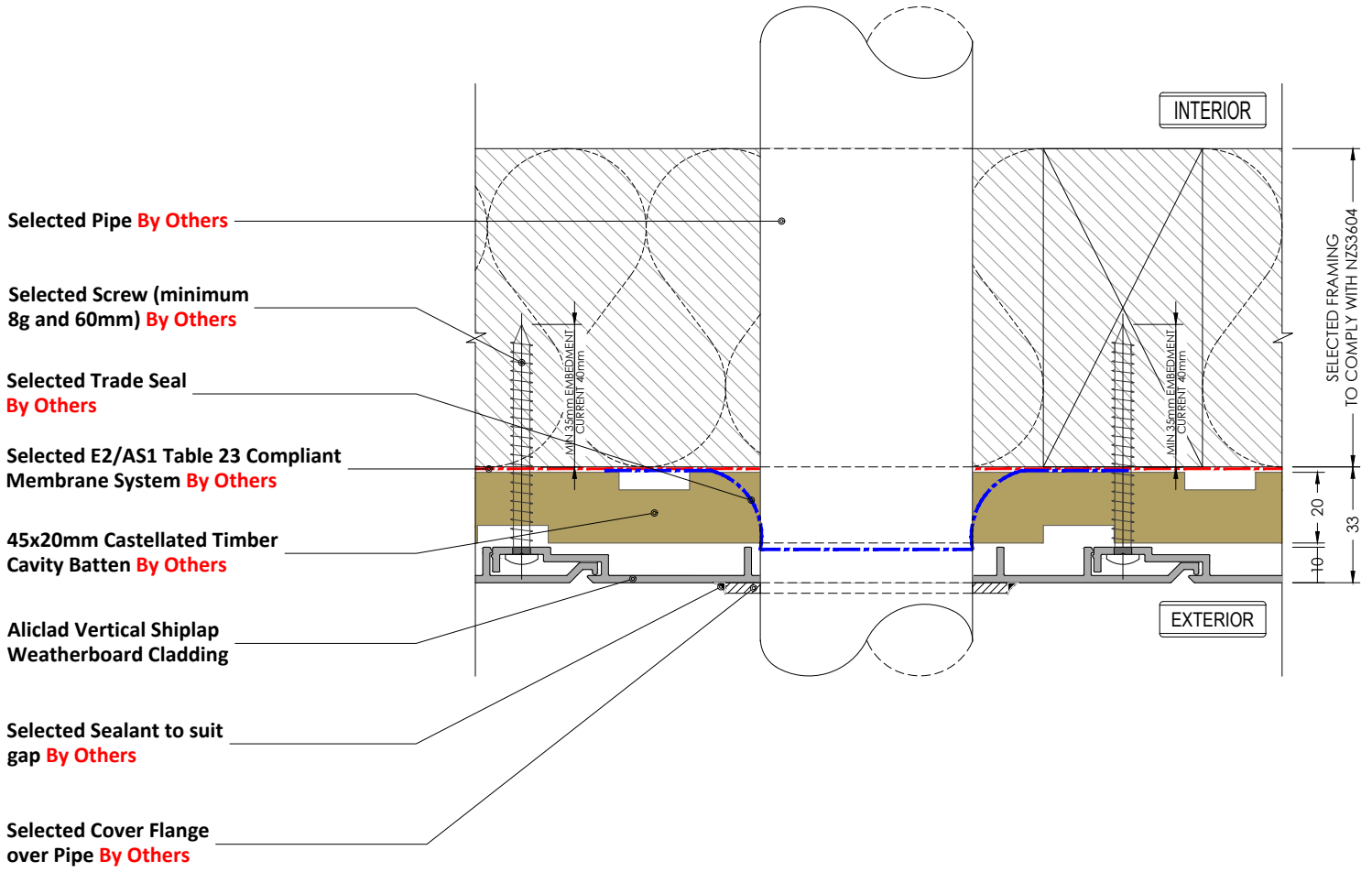

Refer to Test Report  
SWTL R0067



## TYPICAL SMALL PENETRATION

Detail Number \_\_\_\_\_ 9.2  
 Scale \_\_\_\_\_ Version \_\_\_\_\_  
 A4 1:2 [1.0] - Aug 2024

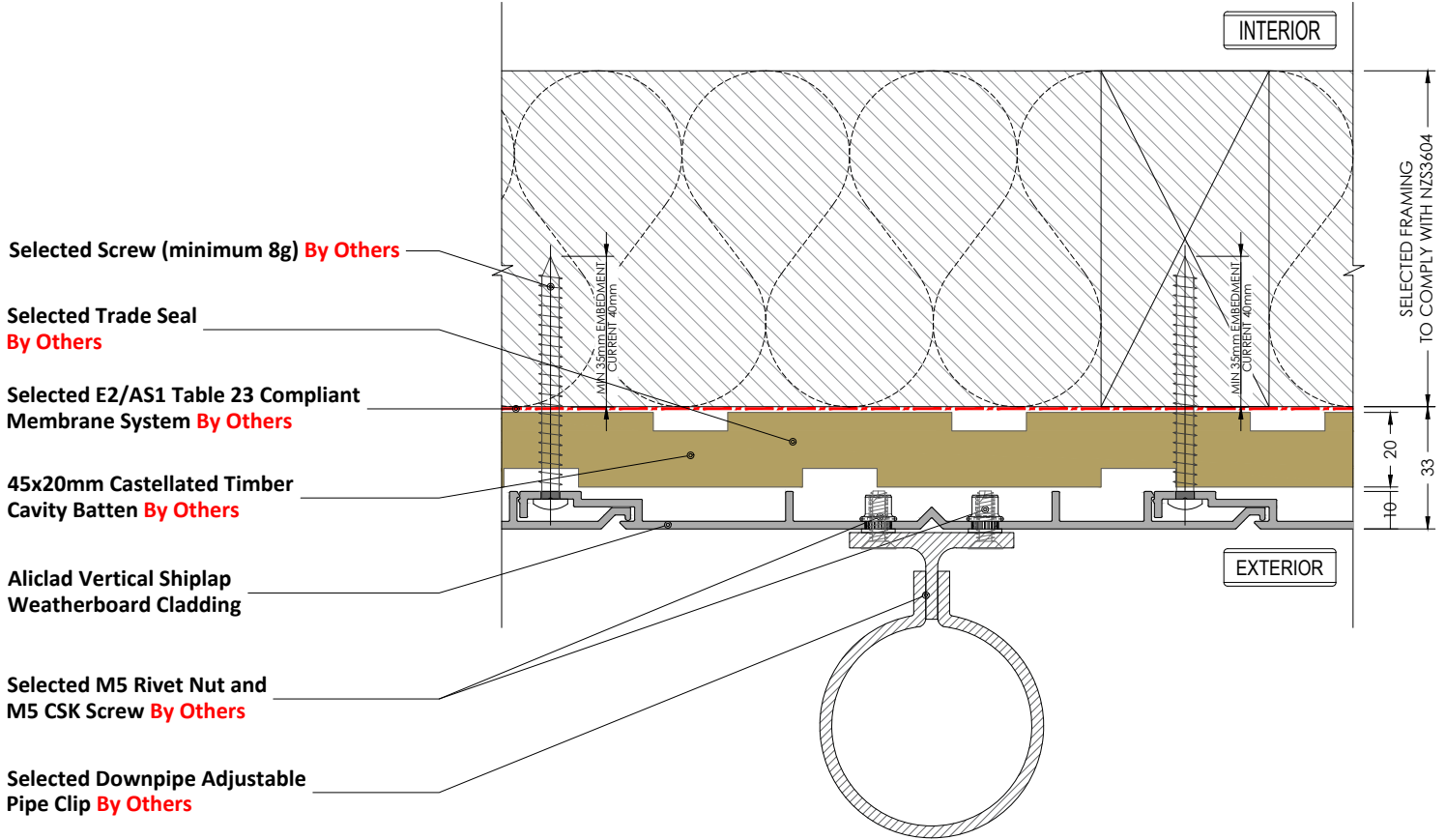

Refer to Test Report  
SWTL R0067



## TYPICAL DOWNPIPE CLIP DETAIL

Detail Number \_\_\_\_\_  
Scale \_\_\_\_\_ Version 9.2  
A4 1:2 [1.0] - Aug 2024